



CONTRA COSTA  
EMERGENCY OPERATIONS CENTER





**Bio-retention basins and pervious paving manages 100% of the anticipated rainwater runoff, keeping it out of the country storm water system**

**CONTRA COSTA  
EMERGENCY OPERATIONS CENTER**

**EMBRACING SUSTAINABILITY**





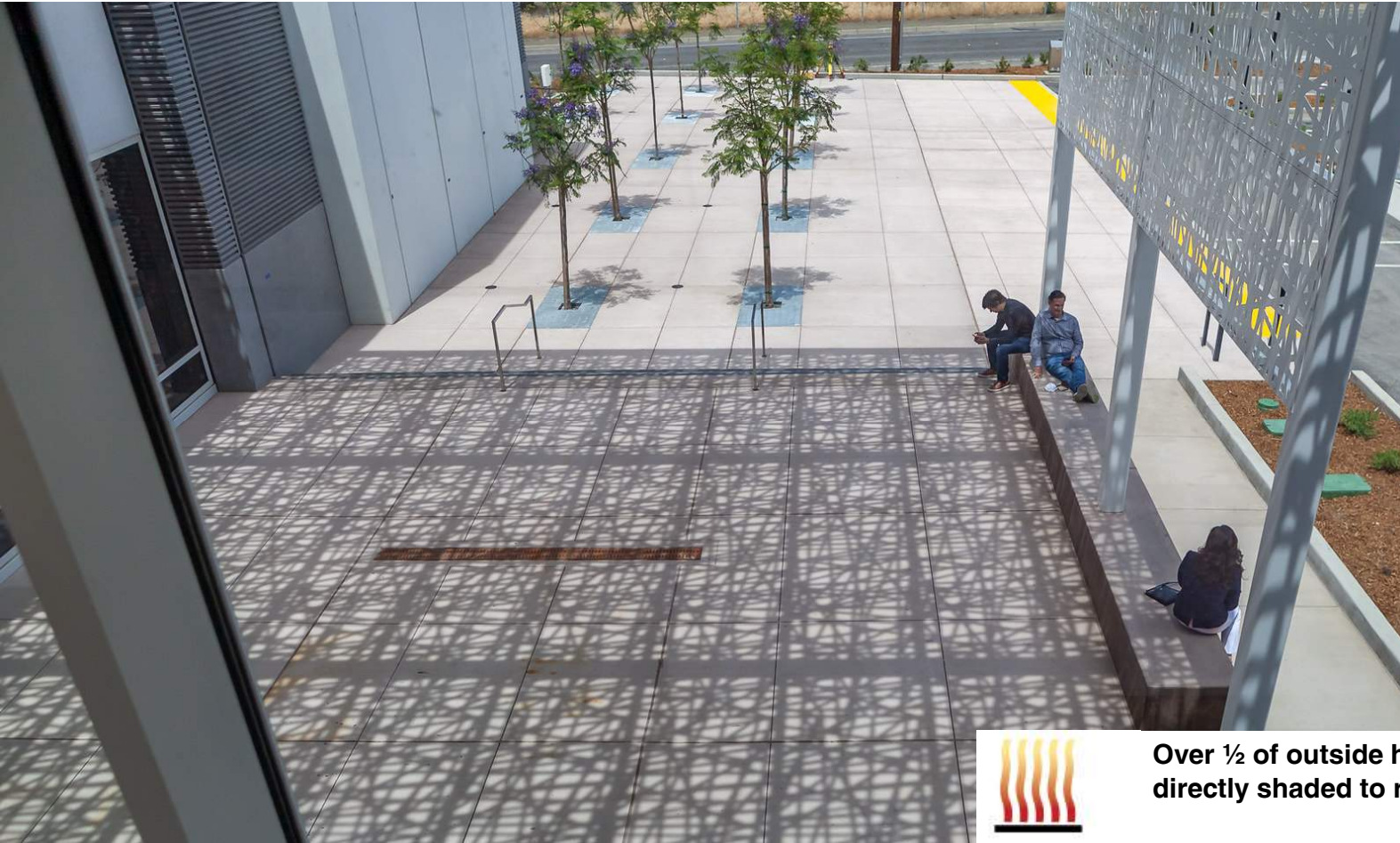

Over ½ of outside hardscape has a high SRI value or is directly shaded to reduce heat island effect

CONTRA COSTA  
EMERGENCY OPERATIONS CENTER

EMBRACING SUSTAINABILITY

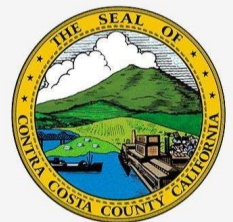



All exterior light fixtures minimize site light pollution for the lowest night light spill

CONTRA COSTA  
EMERGENCY OPERATIONS CENTER

**EMBRACING SUSTAINABILITY**







Indoor water use is reduced by over 35% through low flow fixtures

CONTRA COSTA  
EMERGENCY OPERATIONS CENTER

**EMBRACING SUSTAINABILITY**





**LED lighting with daylight sensors throughout the building**

**CONTRA COSTA  
EMERGENCY OPERATIONS CENTER**

**EMBRACING SUSTAINABILITY**





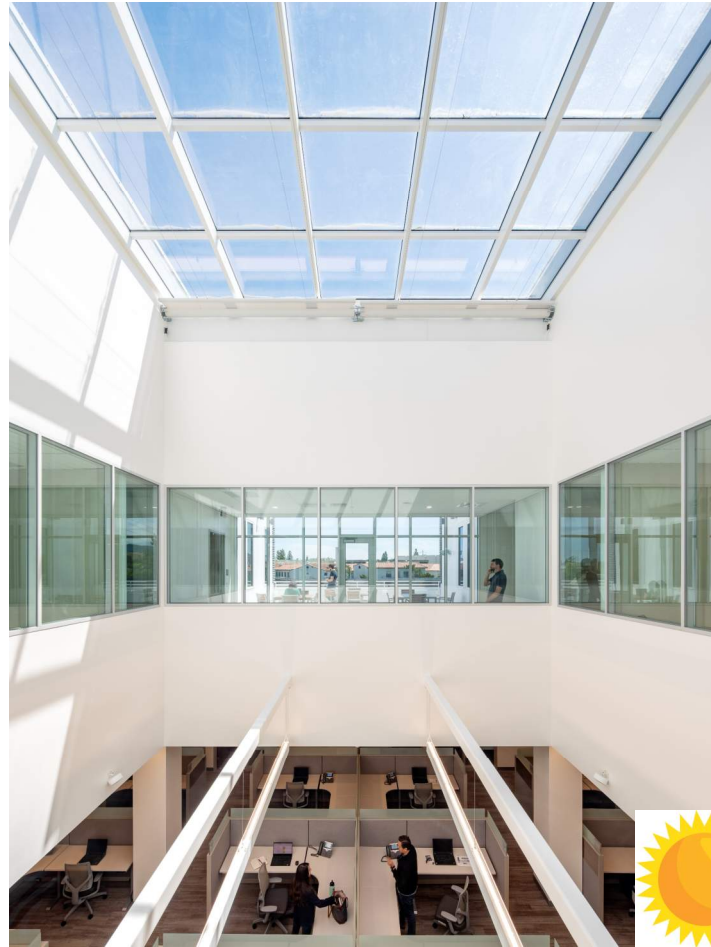

**Access to daylighting with atrium spaces.**

**CONTRA COSTA  
EMERGENCY OPERATIONS CENTER**

**EMBRACING SUSTAINABILITY**





Heating the building with variable flow high-efficiency air cooled heat pump chillers that provide heat with the least amount of energy draw by reading the temperature and adjusting automatically.

CONTRA COSTA  
EMERGENCY OPERATIONS CENTER

EMBRACING SUSTAINABILITY







**PV panels on site will generate enough to cover the building's energy load and return more back to the system.**

**(equivalent of 30 homes a year)**

**CONTRA COSTA  
EMERGENCY OPERATIONS CENTER**

**EMBRACING SUSTAINABILITY**





**Material transparency has been an important aspect of the project, with 30 EPDs and 35 HPDs reported. EPD support material transparency at product life cycle level and HPDs showcase material ingredients.**

CONTRA COSTA  
EMERGENCY OPERATIONS CENTER

**EMBRACING SUSTAINABILITY**







The project was successful in diverting at least 86% of construction and demolition waste from landfill.

CONTRA COSTA  
EMERGENCY OPERATIONS CENTER

EMBRACING SUSTAINABILITY

